

LOCATION MAP
SCALE: 1" = 2000'

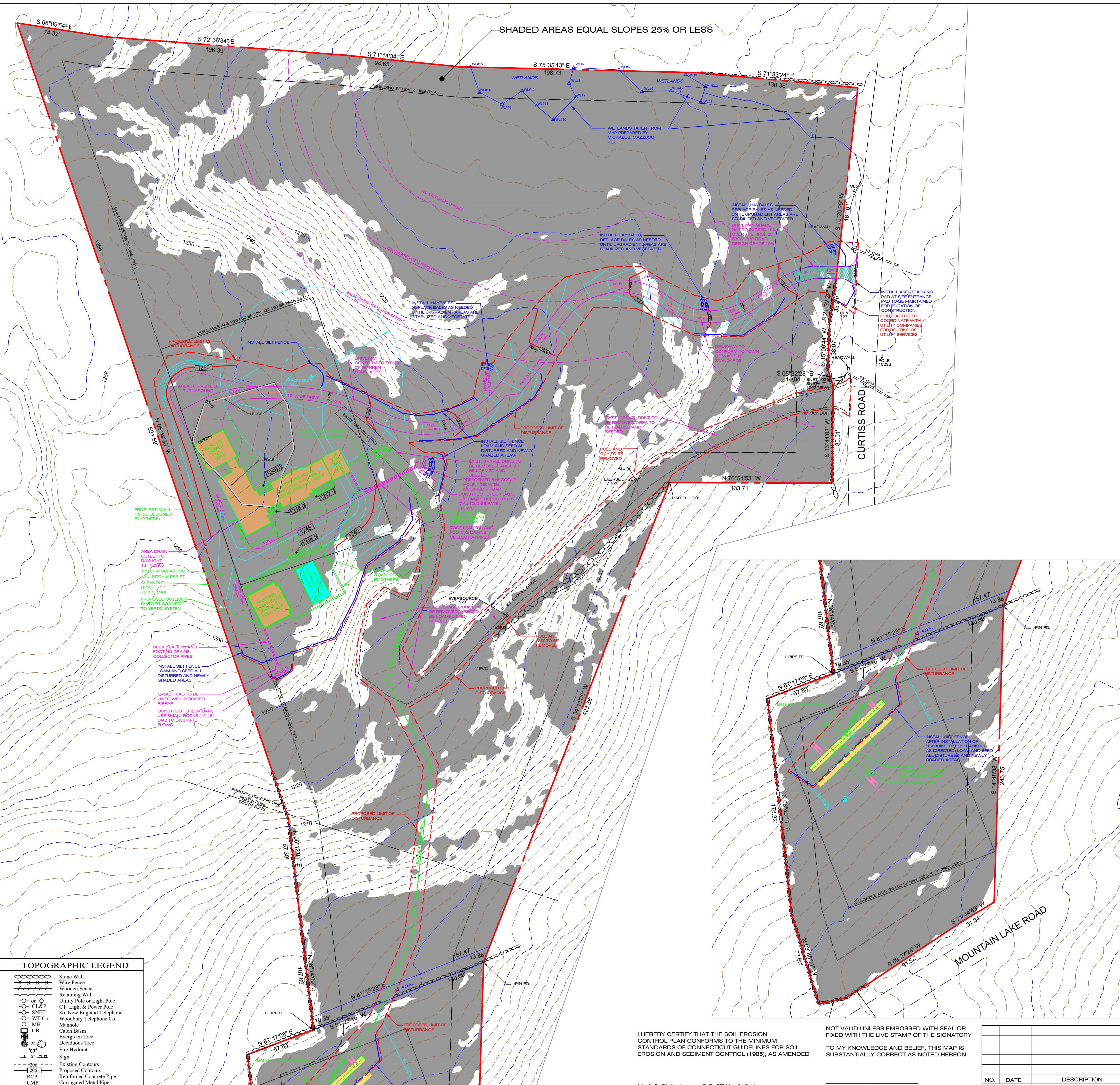

- NOTES**
1. THIS SURVEY AND MAP HAS BEEN PREPARED IN ACCORDANCE WITH THE SECTIONS 20-300B-1 THROUGH 20-300B-20 OF THE REGULATIONS OF CONNECTICUT STATE AGENCIES - MINIMUM STANDARDS FOR SURVEY AND MAPS IN THE STATE OF CONNECTICUT AS ENDORSED BY THE CONNECTICUT ASSOCIATION OF LAND SURVEYORS, INC. IT IS A DATA ACCUMULATION PLAN BASED UPON A RESURVEY AND THE BOUNDARY DETERMINATION CONFORMS TO HORIZONTAL CLASS "A-2".
 2. THIS PROPERTY IS SUBJECT TO ANY AND ALL PROVISIONS OF ANY STATUTE, ORDINANCE, MUNICIPAL REGULATION, PLANNING, ZONING OR WETLAND REGULATION; BUILDING LINE; PRIVATE OR PUBLIC UTILITY EASEMENT; LOCAL, STATE, FEDERAL OR PRIVATE RESTRICTION OR LAW; OR CLAIMS OF ADVERSE POSSESSION WHICH MAY AFFECT THE PREMISES. UNLESS OTHERWISE NOTED, THIS SURVEY DOES NOT NECESSARILY REFLECT ANY SUBSURFACE UTILITY LINES, WETLAND OR FLOOD PLAIN SOILS, BURIED DEBRIS OR OTHER SUBSURFACE ENCROACHMENTS, NOR DOES IT NECESSARILY REFLECT THE EXISTENCE OF ANY WASTE DUMPS OR HAZARDOUS MATERIALS. RIGHTS TO OCCUPANCY OR POSSESSION BY ANY INDIAN NATION OR TRIBE OF INDIANS OR THE CLAIM OF ANY GOVERNMENTAL BODY HAVE NOT BEEN INVESTIGATED BY THIS OFFICE.
 3. THE NORTH ARROW BEARING IS PER MAP REFERENCE 2. THE VERTICAL DATUM IS BASED ON NAVD 88 DATUM.
 4. AT THE AREA OF THE PROPOSED HOUSE AND EXISTING DRIVEWAY, THE CONTOURS DEPICTED REPRESENT A CLASS T-2 TOPOGRAPHIC SURVEY PURSUANT TO THE REGULATIONS OF CONNECTICUT STATE AGENCIES SECTIONS 20-300B1 AND 20-300B2 AND THE STANDARDS FOR SURVEYS AND MAPS IN THE STATE OF CONNECTICUT AS ADOPTED BY THE CONNECTICUT ASSOCIATION OF LAND SURVEYORS, INC. ON SEPTEMBER 26, 1996. THESE CONTOURS ARE THE RESULT OF A TOPOGRAPHIC SURVEY PREPARED BY THIS OFFICE. ALL OTHER CONTOURS DEPICTED ARE BASED ON STATE OF CT LIDAR (2016).
 5. THE WARREN INLAND-WETLANDS AGENCY EXERCISES REGULATORY AUTHORITY OVER ACTIVITIES WITHIN 100' AND UP TO 200' OF WETLAND AREAS AND WATERCOURSES.
 6. THE LIMITS OF INLAND WETLAND SOILS SHOWN HEREON WERE DELINEATED BY OTHERS AND WERE TAKEN FROM A MAP PREPARED BY MICHAEL A. MAZZUCCO, P.C.
 7. IT IS THE OWNERS AND/OR RESPONSIBILITY TO OBTAIN ANY AND ALL REQUIRED PERMITS AND/OR VARIANCES THAT MAY BE REQUIRED PRIOR TO ANY CONSTRUCTION ACTIVITIES.
 8. SUBJECT TO THE APPROVAL OF THE APPROPRIATE MUNICIPAL AGENCIES.
 9. PROPOSED CALCULATIONS ARE BASED ON ARCHITECTURAL PLANS SUBMITTED BY THE ARCHITECT IN SOME CASES DIMENSIONS ARE SCALED. IT IS THE CONTRACTORS RESPONSIBILITY TO ADJUST FOR SIDING THAT WILL BE ADDED TO THE STRUCTURE WITH RESPECT TO COVERAGE AND SETBACKS. THE SURVEYOR ASSUMES NO RESPONSIBILITY FOR DETAILS THAT ARE NOT SUBMITTED FOR OUR REVIEW.
 10. TOTAL AREA OF LOT IS 8.412 +/- ACRES.
 11. THIS PROPERTY IS SITUATED WITHIN THE NORTH AND SOUTH ZONE RESIDENTIAL DISTRICT.

- REFERENCES**
1. FOR TITLE TO PROPERTY, SEE WARRANTY DEED DATED NOV. 16, 2022, WHEREIN ELLIOTT B. DAVIS CONVEYED A PARCEL OF LAND KNOWN AS 152 CURTISS ROAD, WARREN, CT TO JOHN E. & KAREN C. MULLEN WHICH DEED IS RECORDED AT VOL. 97 PAGE 467.
 2. MAP ENTITLED, "PROPERTY/BOUNDARY SURVEY, MAP SHOWING FIRST CUT" DATED APRIL 2013, REVISED OCT. 2014, PREPARED BY SAMUEL P. BERTACCINI, JR. (ON FILE MAP 912).

IMPORTANT NOTE:
Additional underground utilities may exist
Prior to any excavation or construction,
Contact:
"CALL BEFORE YOU DIG" 1-800-922-4455

PROPERTY LEGEND	TOPOGRAPHIC LEGEND
SB Concrete Monument	Stone Wall
CHD Stone Bound	Wire Fence
USGS U.S. Geological Survey Mon.	Wooden Fence
IP Iron Pipe	Retaining Wall
D.H. Drill Hole	Utility Pole or Light Pole
B.P. Brass Pin	CL&P CT. Light & Power Pole
S&T Stake and Tack	SNET Sa. New England Telephone
H.S. Heap of Stones	WT Co. Woodbury Telephone Co.
F.P. Fence Post	MH Manhole
Ex. Existing	CB Catch Basin
FD. Found	Evergreen Tree
NF. Now or Formerly	Deciduous Tree
Prop. Property Line	Fire Hydrant
Assumed Street or Highway Line	Sign
Same Owner Each Side	Existing Contours
Wetland Flag (numbered)	Proposed Contours
	RCP Reinforced Concrete Pipe
	CMP Corrugated Metal Pipe
	CPP Corrugated Polyethylene Pipe

I HEREBY CERTIFY THAT THE SOIL EROSION CONTROL PLAN CONFORMS TO THE MINIMUM STANDARDS OF CONNECTICUT GUIDELINES FOR SOIL EROSION AND SEDIMENT CONTROL (1985), AS AMENDED

Mark S. Riefenhausner, P.E. CT No. 21714

NOT VALID UNLESS EMBOSSED WITH SEAL OR FIXED WITH THE LIVE STAMP OF THE SIGNATORY
TO MY KNOWLEDGE AND BELIEF, THIS MAP IS SUBSTANTIALLY CORRECT AS NOTED HEREON

Charles S Spath Jr., L.S. #70056

NO.	DATE	DESCRIPTION

**SITE DEVELOPMENT PLAN
OVERALL PARCEL**

PREPARED FOR
JOHN E. & KAREN C. MULLEN
152 CURTISS ROAD
WARREN, CT

SCALE: 1" = 40' MAP DATE: 03-07-24

SMITH & Company
Surveyors & Engineers
247 Main Street South, Woodbury, CT. 06798-0996 Tel. 203.263.0068

DRAWN MSR

CHECKED -

SHEET 1 of 4

0 1 2 3 4 5
INCHES ON ORIGINAL

COPYRIGHT AS OF DATE IN TITLE BY SMITH & COMPANY. ALL RIGHTS RESERVED. REPRODUCTIONS OF THIS DRAWING OR ALTERATIONS THEREON WITHOUT WRITTEN PERMISSION OF SMITH & COMPANY ARE PROHIBITED.
ALL FIELD NOTES AND ORIGINAL DRAWINGS REMAIN THE PROPERTY OF SMITH & COMPANY.